



RICHMONDS



## 17 Hepworth Close, Southampton, SO19 0SX

£199,995

A one bedroom end of terrace house with a private rear garden. Features include a kitchen, spacious lounge/dining room and good sized bedroom with study area and bathroom on the first floor. The property is positioned along a private pathway with parking available at the rear. Southampton City Council own and maintain the parking area. This home is ideally located for easy access to Southampton City Center and good transport links. An internal inspection is strongly recommended

### Other Information

Tenure: Freehold

Approximate Age: 1980's

Heating: Gas central heating

Windows: Double glazing

Energy Rating: D

Sellers Position: Found a property they would like to purchase

### Local Information:

Council Tax: Band B

Local Authority: Southampton City Council



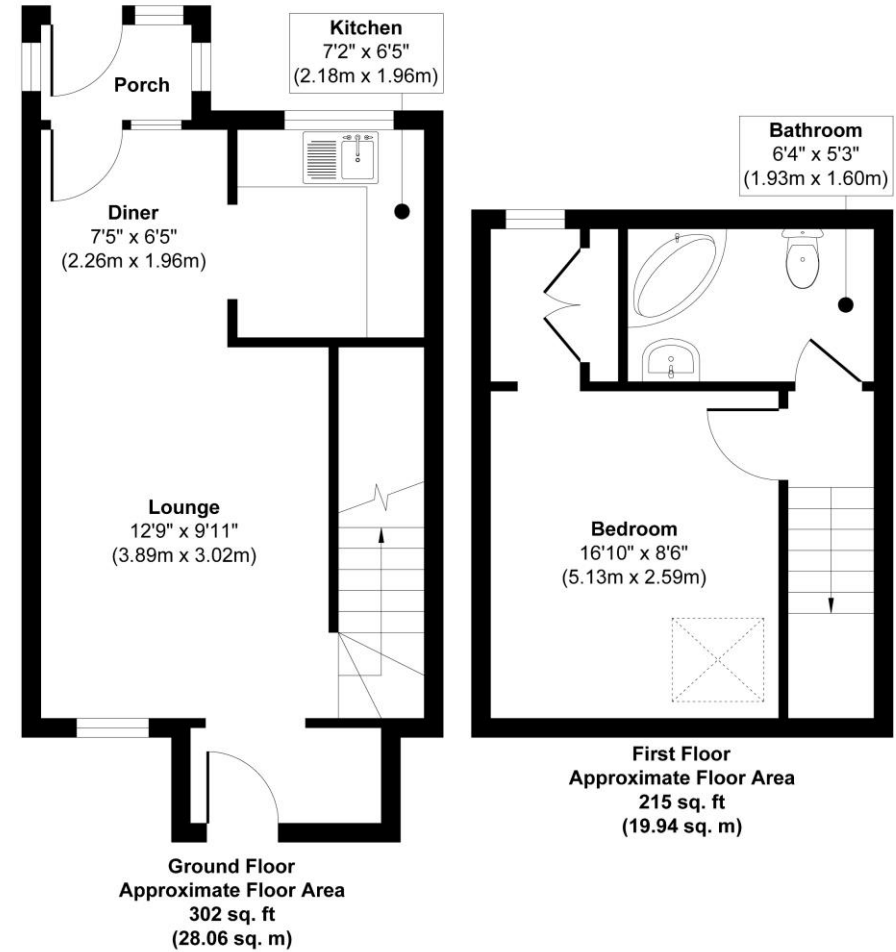

**Approx. Gross Internal Floor Area 517 sq. ft / 48.00 sq. m**  
Illustration for identification purposes only, measurements are approximate, not to scale.  
 Produced by Elements Property

**Agents Note:** The sellers of the property have provided the above information to us and we are therefore reliant on them providing the correct information. The floor plan and sizes are to be used as a guide only. Please check room sizes prior to ordering carpets or furniture. If you require confirmation on any particular point for specific purposes please contact our office for further information. If you have other questions about this property, please telephone **01489 789933**

R545 Ravensworth 01670 713330

**Lankester House, 1 Freegrounds Road, Hedge End, Southampton SO30 0HG • 01489 789933 • [admin@richmondsproperty.co.uk](mailto:admin@richmondsproperty.co.uk)**



